

## Classic RN 120

### DATA SHEET

#### Description

The characteristics of the HEINZMANN e-bike drive Classic are the robust technology combined with the innovative optimisation of its components and features.

The DC motor provides a consistent, powerful performance at economical use of the battery power. The integrated gears result in strong torque, providing maximal support to the rider, even at steep inclines or with heavy loads. All mechanical parts are well protected by the sealed housing. The power electronics is not integrated into the motor, allowing even greater performance since the motor temperature does not impact the function of the electronics. For safety, a temperature safety switch is integrated in the motor.



#### Features

Powerful, proven DC drive

Gears for maximum torque

Front wheel or rear wheel assembly possible

Separate power electronics not impacted by motor temperature, delivering greater performance

#### Technical data

Wheel size	26"	28"
<b>Motor</b>		
Rated power	250 W	
Nominal speed	209 1/min	180 1/min
Cooling ext. ventilation	> 5 m/s	
Moment of inertia	900 kg·cm <sup>2</sup>	
Weight	3.5 kg	
<b>Electrical data</b>		
Nominal voltage	36 VDC	
System of protection	IP54	
EMF constant	16.7 V/100min <sup>-1</sup>	19.2 V/100min <sup>-1</sup>
Torque constant	1.59 Nm/A	1.83 Nm/A
Armature resistance	0.250 Ω	0.275 Ω
Armature inductance	0.06 mH	0.07 mH

Wheel size	26"	28"
<b>Sensor system</b>		
Temperature sensor	Temperature switch 145 °C	
<b>Operating points</b>		
Operational mode	S1	
Rated torque	11.4 Nm	13.2 Nm
Rated current	9.5 A	8.7 A



# Dimensions

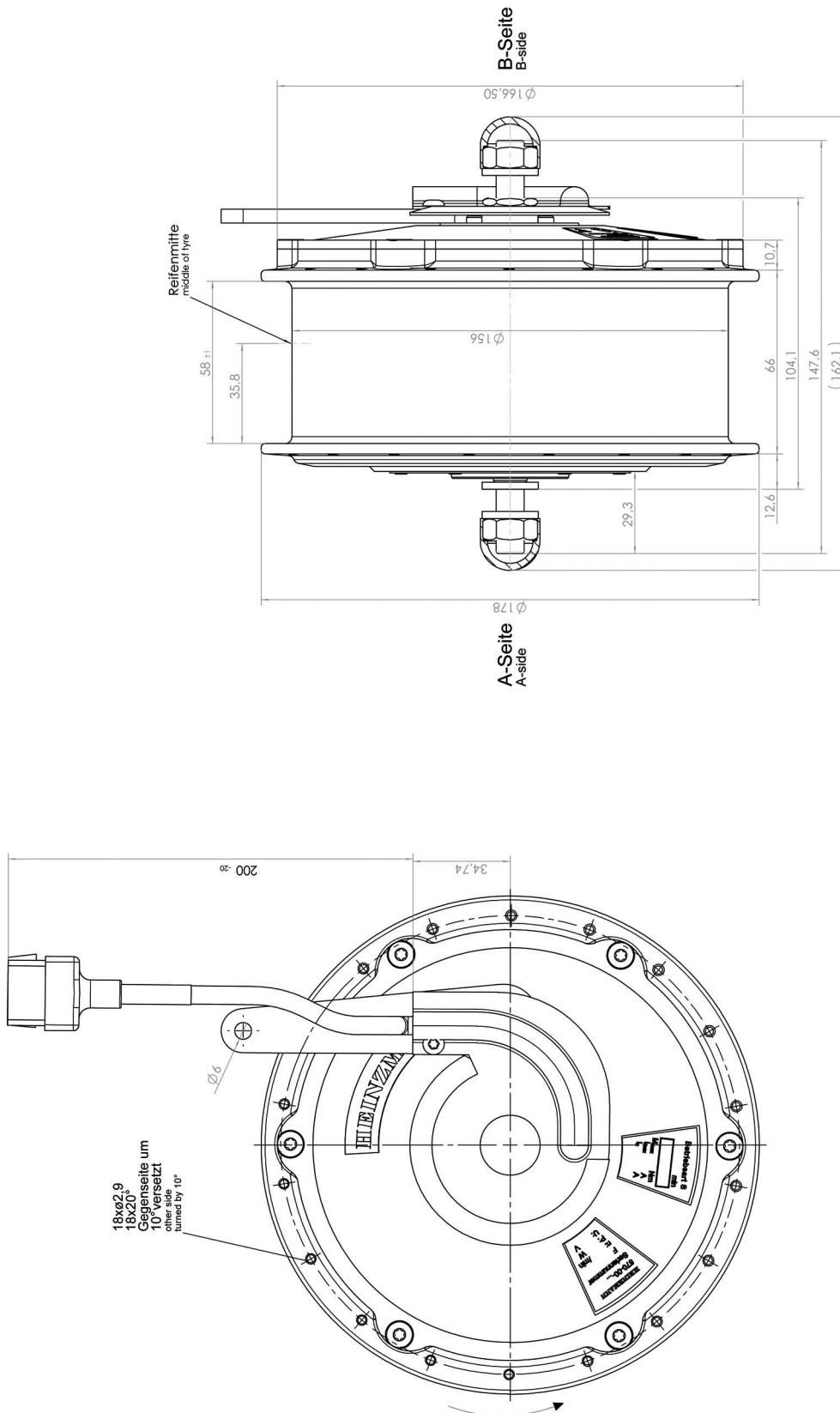

With this drawing the regulations for copy right protection are effective.

Subject to alterations. ©HEINZMANN GmbH & Co. KG, 2012